



Mix&Match to Get What You Need

Donaldson's Mix&Match system provides the great performance and functional advantages of custom-engineered filters with the convenience and speedy delivery of in-stock parts. Choose your options and build a filter model that exactly suits your cleanliness requirements.

Technical Data

- Operating pressure up to 1000 kPa (10 bar).
- Static pressure testing up to 1500 kPa (15 bar).
- By-pass valve setting 30 kPa (0,3bar) per ISO 3968.
- Operating temperature -20 +120°C.
- Compatibility with hydraulic fluids per ISO 2943.
- Flow rate and pressure drop determined per ISO 3968 with oil kinematic viscosity 30 cSt at 40°C and density 0,875 kg/dm³.

Filter Elements

- Operating pressure up to 1000 kPa (10 bar).
- Static pressure testing up to 1500 kPa (15 bar).
- Collapse resistance 1000 kPa (10 bar) per ISO 2941.
- Wire mesh: 60 micron.
- Cellulose media: 36-50 micron.
- Synteq® synthetic media: 11-23 micron.



Components

	WIRE MESH MEDIA		CELLULOSE MEDIA				SYNTHETIC MEDIA				CARTRIDGE CODE
	/6		/3		/1		/03		XP10		
	60µm		$\beta_{50\mu m(c)} \geq 1000$		$\beta_{36\mu m(c)} \geq 1000$		$\beta_{23\mu m(c)} \geq 1000$		$\beta_{11\mu m(c)} \geq 1000$		
Family	RMF		RMF		RMF		RMF		RMF		
FACA60	30	P171607	25	P171606	20	P550268	15	P171604	15	P171602	CA60
FACA80	35	P171612	30	P171611	25	P171610	20	P171609	20	P171608	CA80
FACA108			50	P764638							CA108
FACA118			60	P763987							CA108
FACA160	80	P171617	80	P171616	70	P550148	60	P171614	60	P171613	CA160
FACA200	100	P171622	100	P171621	90	P171620	80	P171619	80	P171618	CA200
FACA380	190	P171617	190	P171616	170	P550148	150	P171614	150	P171613	CA160
FACA400	200	P171622	200	P171621	180	P171620	180	P171619	180	P171618	CA200
FACA220			100	P764410					80	P764411	CA220
FACA250			120	P764409					90	P763668	CA250

RMF = Recommended Maximum Flow in liters/minute with use of standard head.
BPV = Bypass Valve Setting

Heads Choices



Head for Family	Part	Ports	Bypass Valve Setting	Indicator Info			Snout	Mounting holes
				Drilled holes for indicator	Side	Indicator to use		
FACA 60/80	P561140	1 1/16 SAE	0,3 bar	no	-	none	1-12 UNF	M8
	P563288	1/2-14 NPTF	1 bar	plugged	left + right	P563979 or P563299	1-12 UNF	1/4-20 UNC
	P561138	3/4-16 UNF	1,7 bar	no	-	none	1-12 UNF	1/4-20 UNC
	P761262	G3/4	0,3 bar	plugged	left + right	P171954, P171959, P171967 or P173105	G3/4	M8
	P173442*	G3/4	0,3 bar	no	-	none	G3/4	M8
	P175001	G3/4	no opening	plugged	left + right	P171954, P171959, P171967 or P173105	G3/4	M8
FACA 160/200	P761259	G1 1/4	0,3 bar	plugged	left + right	P171954, P171959, P171967 or P173105	G1 1/4	M8
	P173203*	G1 1/4	0,3 bar	no	-	none	G1 1/4	M8
	P762638	G1 1/4	1,5 bar	plugged	right	P171954, P171959, P171967 or P173105	G1 1/4	M8
	P173403	G1 1/4	no opening	plugged	left + right	P171954, P171959, P171967 or P173105	G1 1/4	M8
FACA 220/250	P764420	G1 1/4	0,3 bar	plugged	right	P171954, P171959, P171967 or P173105	1 1/2-16 UN	M10
	P764419*	G1 1/4	0,3 bar	no	-	none	1 1/2-16 UN	M8
	P764421	G1 1/4	no opening	plugged	right	P171954, P171959, P171967 or P173105	1 1/2-16 UN	M8
FACA 380/400	P761260	G1 1/2	0,3 bar	plugged	front	P171954, P171959, P171967 or P173105	G1 1/4	M10
	P766294*	G1 1/2	0,3 bar	no	-	none	G1 1/4	M10

FBK Filters aren't delivered with drilled holes for indicators or bypass valve, heads are.
Unless otherwise mentioned, the usage of indicators is mandatory, because the drilled holes for indicators are not plugged.

* Standard Head

SUCTION FILTERS
IN-LINE



Standard Head	HEAD DIMENSIONS									SPIN-ON DIMENSIONS		
	A	B	C	D	E	F	G	S	BPV	X	Y	Z
		mm	mm	mm		mm	mm	mm	bar	mm	mm	
P173442	G3/4	95	13	41,5	M8	38		20	0,3	146	96	G3/4
										209	96	G3/4
NA										183	108	M40x2
										230	108	M40x2
P173203	G1 1/4	132	28,5	61,5	M8	50		24	0,3	181	128	G1 1/4
										226	128	G1 1/4
P766294	G1 1/2	138	35	70	M10		65	24	0,3	181	128	G1 1/4
										226	128	G1 1/4
P764419	G1 1/4	132	28,5	61,5	M8	50	50	25	0,3	236	136	1 1/2-16UN
										306	136	1 1/2-16UN

FACA 60/80

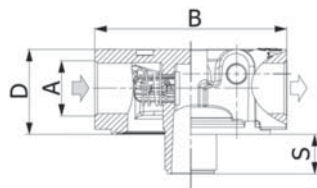

LEFT

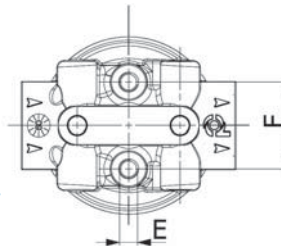

RIGHT

FACA 160/200

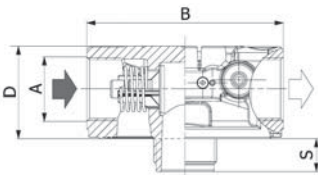

LEFT

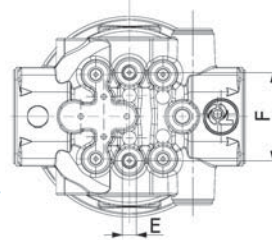

RIGHT

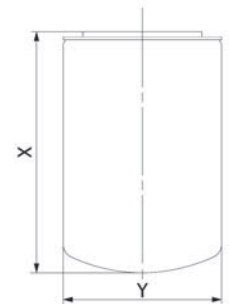

FACA 220/250

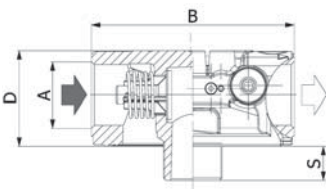

LEFT

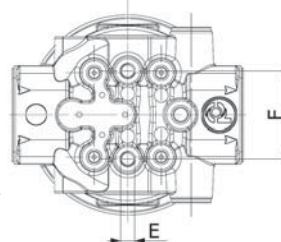

RIGHT

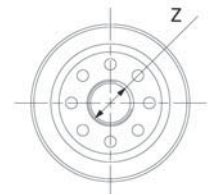

FACA 380/400

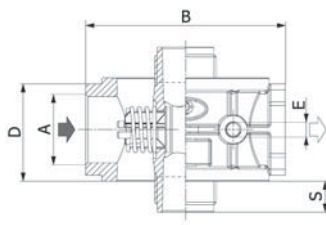

FRONT

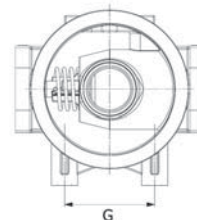

Indicator Choices

Indicator	Kind		Reference Drawing	Setting (bar)	Contact	Protection Class	Cable Clamp	Max. Values
P171967	Electrical	Vacuum	C	-0,3	Normally Open	IP65	PG7	48 V AC - 30 V DC; 0,5 A res. and 0,2 A ind.
P173105	Electrical	Vacuum	C	-0,3	Normally Closed	IP65	PG7	48 V AC - 30 V DC; 0,5 A res. and 0,2 A ind.
P171954	Visual	Vacuum	G	-0,3				
P171959	Visual	Vacuum	N	-0,3				

SUCTION FILTERS
IN-LINE

Installation & Service Guidelines

Important

- The filter head snout must be lubricated before spinning on a new filter to prevent thread damage. Heavyweight gear lube is recommended.
- Oil the O-Rings before assembly.

Performance Curves

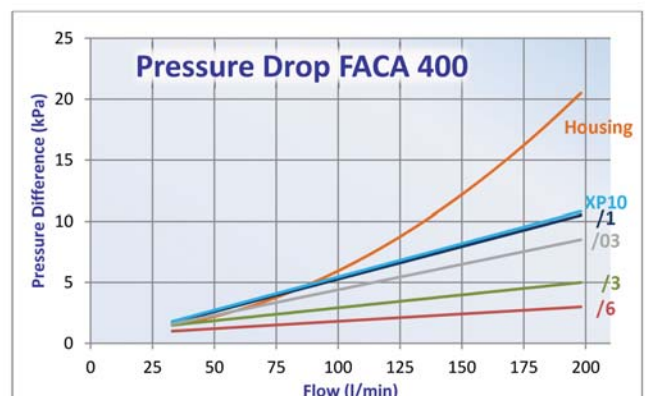
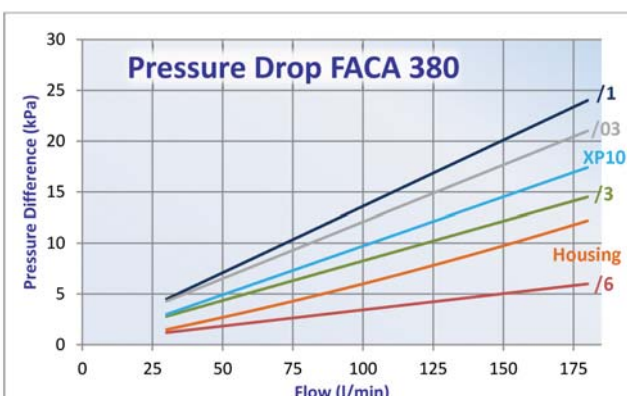
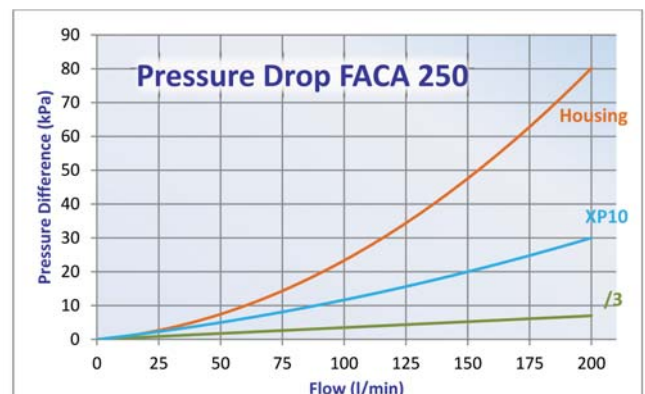
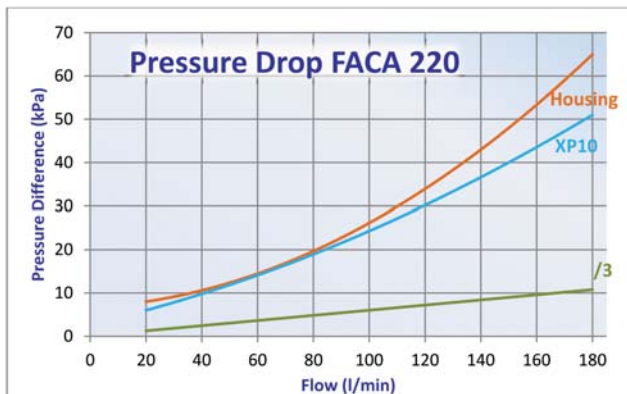
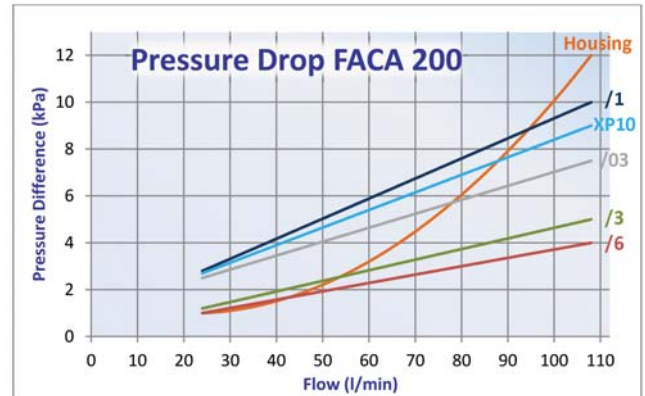
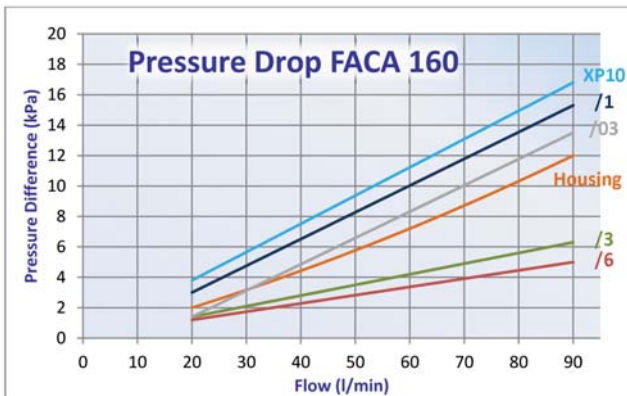
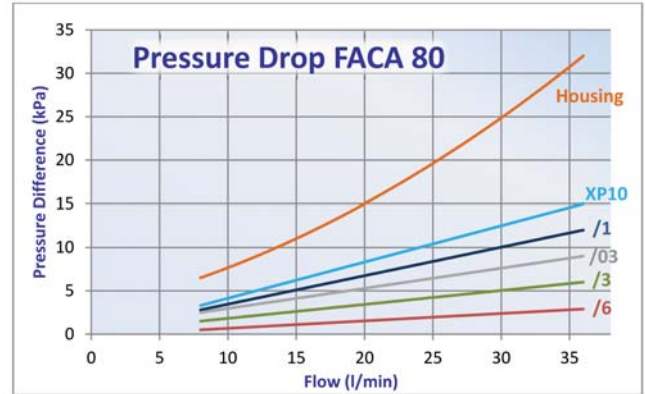
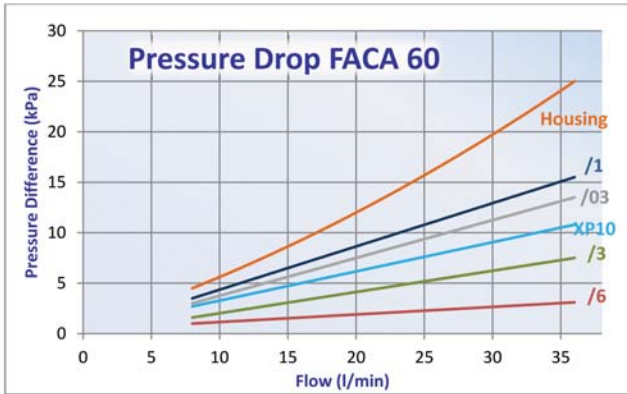

SUCTION FILTERS
IN-LINE

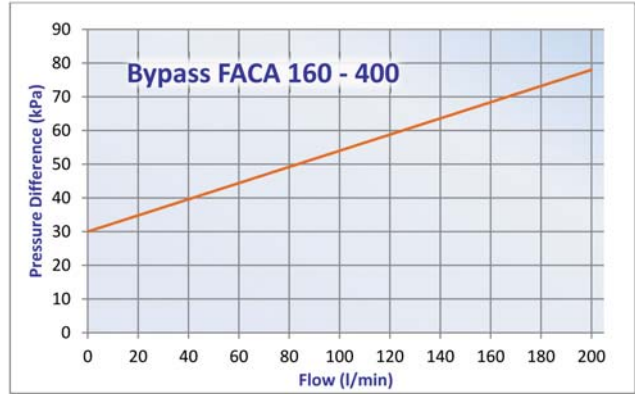
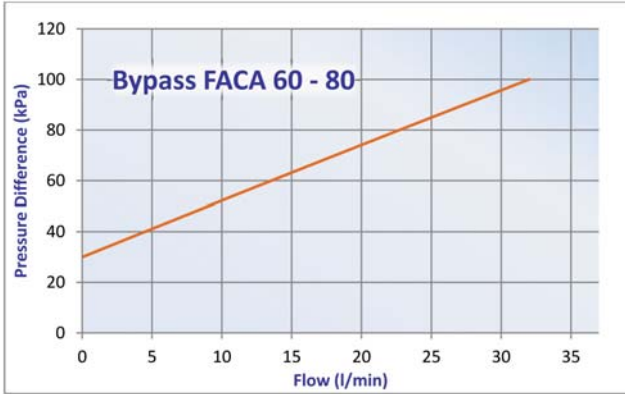

SUCTION FILTERS
IN-LINE